



ENGINEERED FOR MOTION

## 216TX Series Infrared Wireless Touchless Door Activator Switches



216TX-TG

### Product Name

#### 216TX Series

Infrared Wireless Touchless Door  
Activator Switches

### Contact Information

MS SEDCO  
7898 Zionsville Road  
Indianapolis, IN 46268  
Phone: (317) 842-2545  
www.mssedco.com

### Product Description

#### BASIC USE

The 216TX Series wireless touchless switches are infrared devices designed to activate full and low energy automatic doors. The built-in wireless transmitter offers the added benefit of easy installation, requiring no wiring to the switch.

The hands free operation of the 216TX makes them ideal for ADA applications and locations where hygiene is important such as restrooms, health care facilities or cleanrooms. The 216TX is microprocessor controlled, allowing for superior operation in a smaller unit.

The 216TX has a 4 1/2" stainless steel faceplate and comes installed in the 1020 box complete with a transmitter.

### Technical Data

- ADA Compliant Hands-Free, Germ-Free Operation
- Microprocessor-Controlled Active Infrared
- Digital Circuit Design
- Wireless Transmitter Features ClearPath™ Technology With Three User-selectable Frequency Settings (300 MHz, 390 MHz, HDRC™)
- FCC Licenses For All Three Frequency Settings
- SignalLock™ Guarantees Signal Transmission When Presence Is Detected
- Integrated Signal Radiating Antenna Boosts Signal Strength
- Compatible With Most 300 MHz, 390 MHz, and ClearPath™ CP/TX Receivers

### SPECIFICATIONS

#### Detection Method

Amplitude modulated, coded carrier active infrared

#### Avg. Radiated Power

Less than 5 mW/cm<sup>2</sup>

#### Input Voltage

216: 3.3 Volts DC Coin Cell Battery (CR2032)  
TX: 9 Volt DC Battery

#### Response Time

<300 mSeconds

#### Operating Distance

±1 - 5 inches

#### Unit Size

4 3/4"W x 4 3/4"H x 2 1/4"D

#### Mounting Options

Includes wall mount box

#### Face Plate Sizes

4 1/2" square

#### Face Plate Finishes

Standard: Brushed Stainless Steel  
For Special Finishes & Legends,  
Contact Factory

#### Temperature

-4°F to 140°F (-20°C to 60°C)

### APPLICABLE STANDARDS

American National Standards Institute (ANSI) - Building Hardware Manufacturers Association (BHMA) - ANSI/BHMA A156.10 & A156.19.

### Installation

Refer to MS SEDCO Installation Instructions.

### Availability & Cost

#### AVAILABILITY

Available internationally from manufacturer's authorized distributors; contact MS SEDCO for the location of the nearest distributor.

#### COST

Cost information on MS SEDCO products is available from the manufacturer's authorized distributors.

### Warranty

A one year warranty is available from the manufacturer covering defects in materials and workmanship. Contact MS SEDCO for details.

### Maintenance

MS SEDCO recommends that all maintenance and adjustments be performed by an AAADM Certified Technician.

### Technical Services

MS SEDCO's staff of factory trained sales and service personnel offer design assistance and technical support. Local distributors are also available to assist in selecting appropriate devices for specific uses and to provide onsite installation

072017

# 216TX Series Infrared Wireless Touchless Door Activator Switches



ENGINEERED FOR MOTION

### Maintenance

MS SEDCO recommends that all maintenance and adjustments be performed by an AAADM Certified Technician.

### Technical Services

MS SEDCO's staff of factory trained sales and service personnel offer design assistance and technical support. Local distributors are also available to assist in selecting appropriate devices for specific uses and to provide onsite installation.

### AVAILABLE FACE PLATES

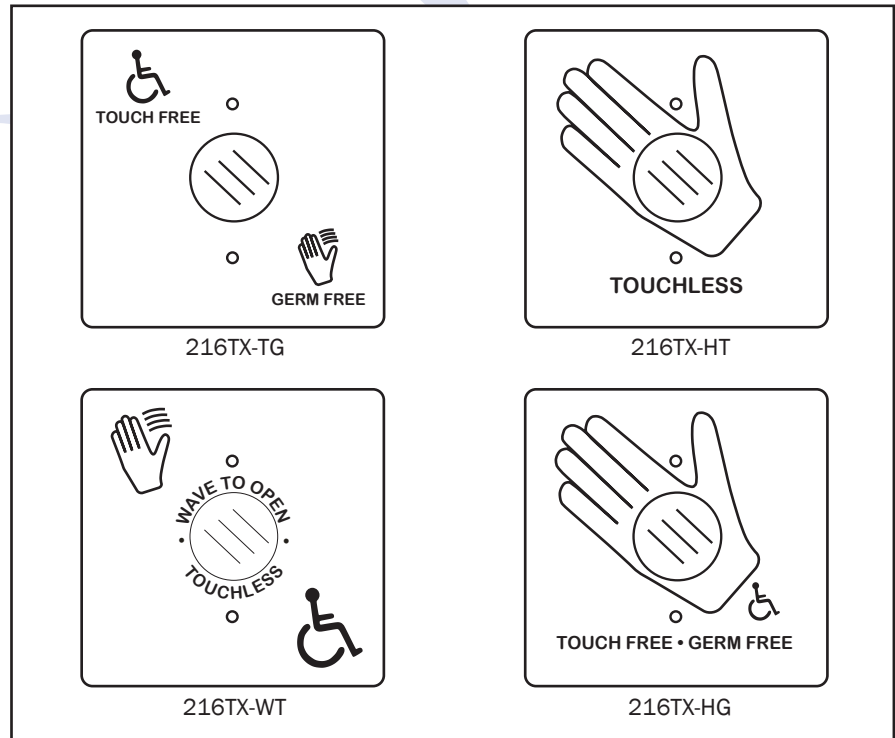

### DIMENSIONS

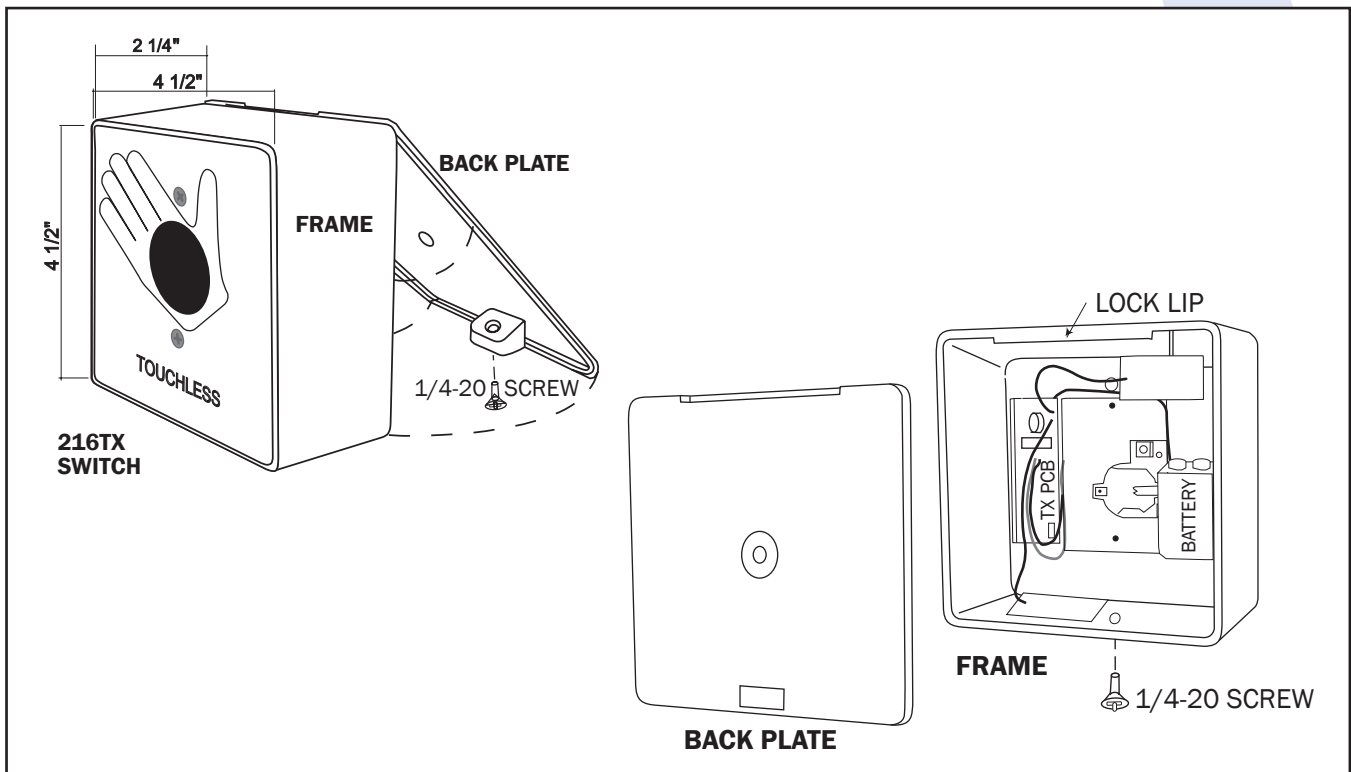

072017