

# NexGen Infrared Touchless Wireless Series

Infrared Touchless Door Activator Switches and Transceiver

INSTALLATION INSTRUCTIONS

## General Description

The NexGen Infrared Touchless actuator is the next generation of automatic door activation switch. The NexGen IR combines the latest advances in infrared sensing technology with durable composite plastics, to create an actuator that is both stylish and tough. NexGen switches are extremely thin and utilize no moving parts. The 4" faceplate is bordered by a clear bezel edge that illuminates upon activation. Their hands free operation makes them ideal for ADA applications. Other applications include clean-room access points, request-to-exit devices (1 amp contact), and point-of-purchase displays. The NexGen Infrared Touchless switch is microprocessor controlled, allowing for superior operation in a smaller unit. The wireless version includes a built-in ClearPath Spectrum transceiver that can be paired to the S-COR coordinator, eliminating the need for wiring.

Contents: (1) NexGen IR Switch, (1) Hardware Pack, and (1) Installation Manual.

## Basic Installation

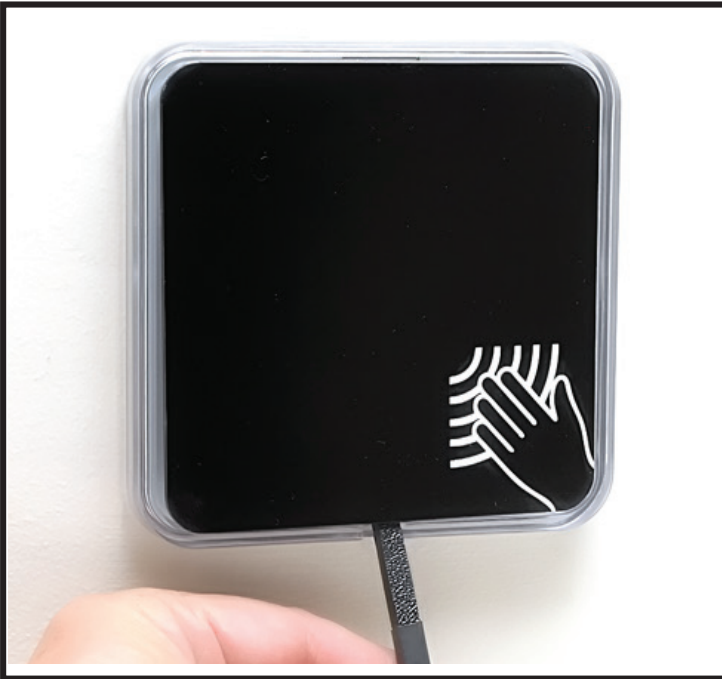

1. Remove faceplate using a screwdriver as shown.

For further technical assistance, contact the factory at 1-317-842-2545.



# NexGen Infrared Touchless Wireless Series

Infrared Touchless Door Activator Switches and Transceiver

INSTALLATION INSTRUCTIONS

## Basic Installation (continued)

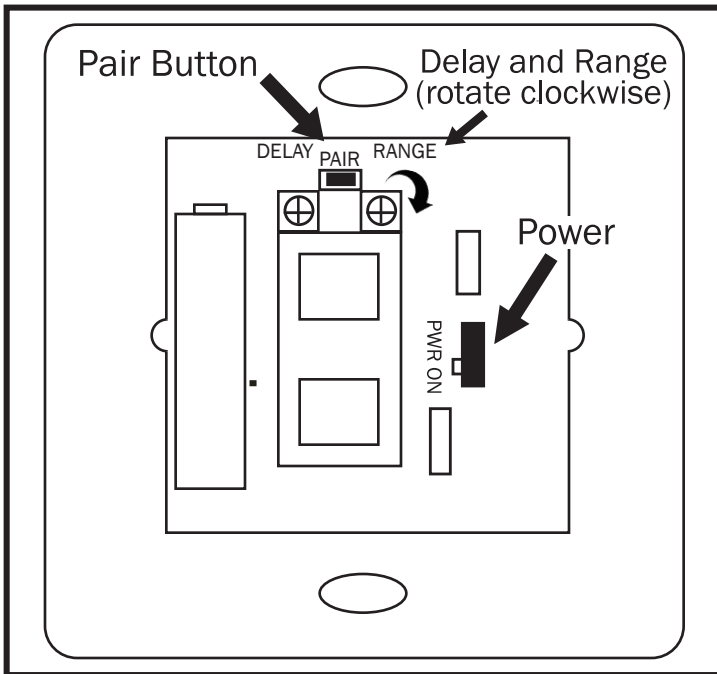

2. Install switch using screws supplied in hardware pack.
3. Adjust range and delay before activation by turning potentiometer using phillips head screwdriver.
4. Insure power is in ON position.
5. Pair NexGen transceiver to S-COR by following procedure outlined in S-COR Installation Instructions.



6. Replace faceplate and test unit to ensure proper operation.

Range adjustment from touch 1" to 5". CCW is minimum. Turn CW to increase.  
Response Time (Delay) adjustable from 0.5 to 2 seconds. Turn CW to increase.

For further technical assistance, contact the factory at 1-317-842-2545.